

Go Green Donate a Tree Enrich the Stadium

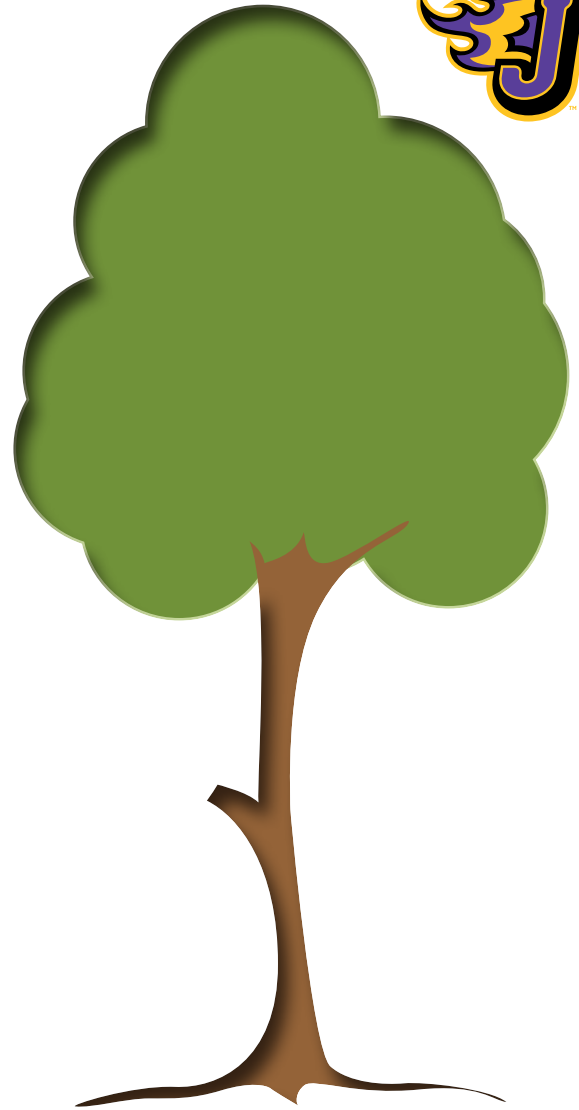

Help add natural beauty to the new Johnston High School athletic complex!

Johnston community members and businesses are invited to donate a tree to be planted outside of the new JHS athletic complex, which was approved for construction earlier this year.

Six trees are still available for purchase - all Eastern White Pine. See reverse side for a layout of where the trees will be placed.

All donors will be acknowledged on a plaque located outside of the athletic complex and notified when the trees are planted.

The new athletic complex will be complete in June 2017 and open for student use for the 2017-18 school year. It will provide more convenience and space for high school, middle school, and community athletic practices and games.

Visit www.johnstoncsd.org for more information.



Stadium Planting Donation Form

Please send form and payment to the Johnston Community School District.
5608 Merle Hay Rd, P.O. Box 10, Johnston, IA 50131

Donor Name: _____

Address _____

City: _____ State: _____ Zip: _____ Phone: _____

Please circle your tree donation choice below:



Eastern White Pine - 8' Height - \$500 (only 6 left!)

Amount Enclosed: \$ _____ (If paying by check, please make payable to Johnston Community School District)

Signature: _____ Date: _____

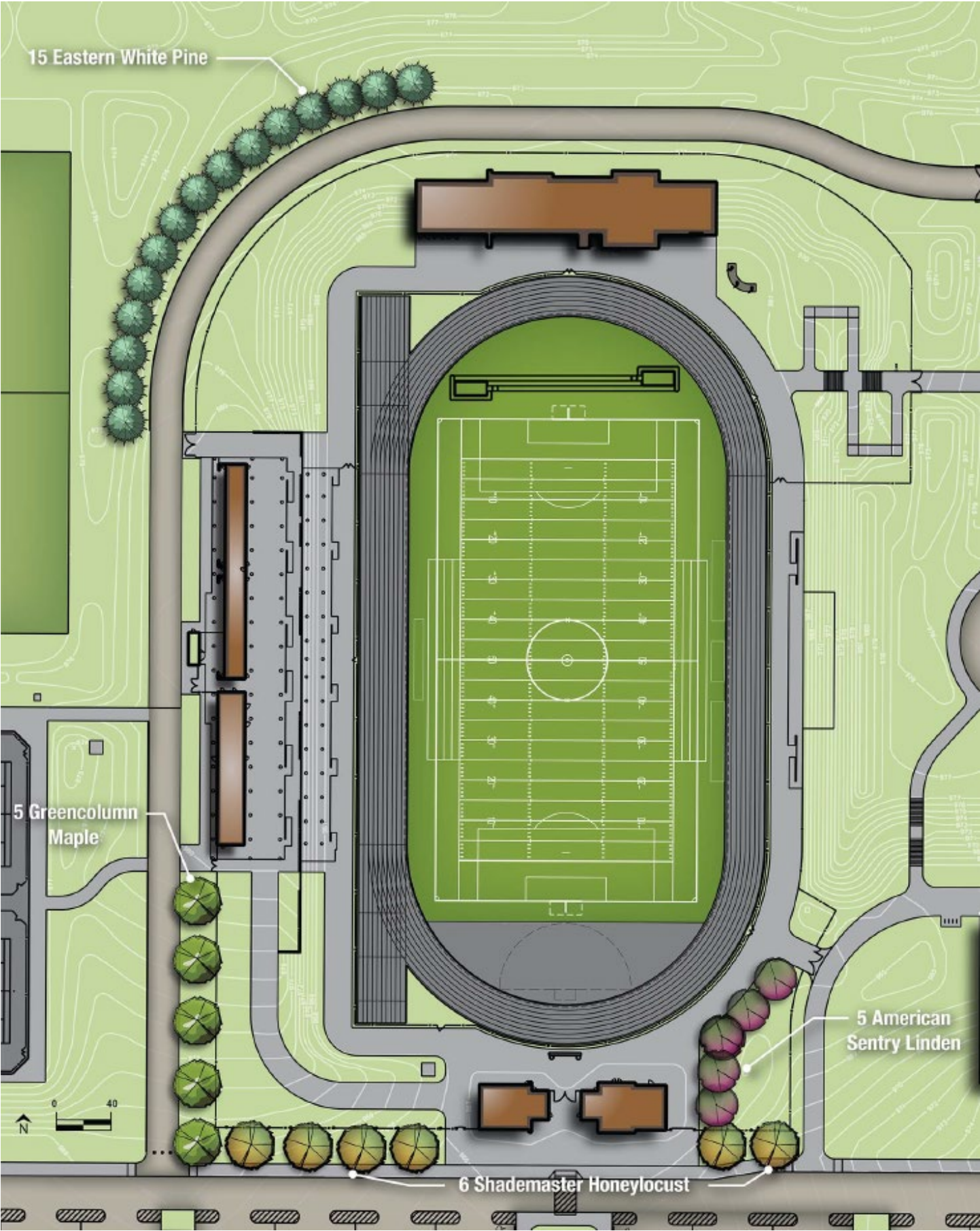

15 Eastern White Pine

5 Greencolumn Maple

5 American Sentry Linden

6 Shademaster Honeylocust